

PRODUCT



Art no: SHP1.01001

Marine Range RIQ 43-21 4pl. W-Oven 14,4kw

IP 44

- Exclusively design for Marine use
- Protection Degre IP44
- Extremley strong construction
- Qick and easy maintance
- Easy to clean
- Demontable for installation on board
- AISI304 S.S Top, External covering feet
- Underneath heavy duty stand with welded shelf and tubular antirolling bar
- High temperature cable
- AISI 304 stainless steel 2mm thikness top enterely welded
- Adjustable and removable stainless steel antirolling-bars
- Plate heating element removable, with 40mm insulatio
- Rated voltage 115/3/60—208/3/50-60—230/3/50-60
400/3/50—415/3/50-60 440/3/60—460/3/50-60—
480/3/60 (*Please specify when ordering)



DATA	◆	◆	◆
DIM (H*W*D)	900mm	800mm	900mm
SHIPPING DIM (H*W*D)			
WEIGHT Gross/Nett Kg			
HS Code			
EORI			
OTHER			

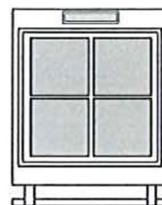

RIQ43-21

4 PIASTRE - HOT PLATES 300x300 mm
1 FORNO - OVEN 540x700x300h mm
POTENZA TOTALE - TOTAL POWER Kw 14,4

Reference Photo



SHOK Partner AS, Reserve the right for model changes without notice!



Technical Details:

Description:	Voltage:	Kw	Water/Drain
Marine Top RIQ43-21	230v 3ph 50-60Hz	14,4	N/A
Marine Top RIQ43-21	440v 3ph 60Hz	14,4	N/A
Marine Top RIQ43-21	400v 3ph 50Hz	14,4	N/A

Drawing Sheet:

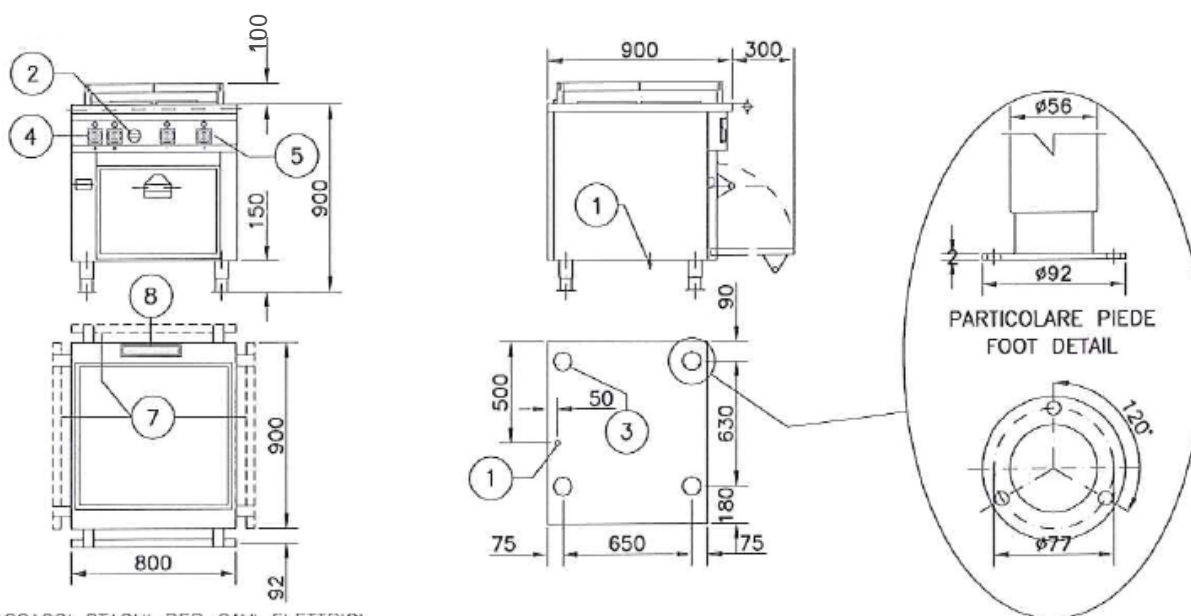

1 PASSAGGI STAGNI PER CAVI ELETTRICI
CORD CONNECTORS

2 TERMOSTATO FORNO
OVEN THERMOSTAT

3 POSIZIONE PER FISSAGGIO PIEDI
FEET FIXING POSITION

4 INTERRUTTORI FORNO
OVEN SWITCHES

5 COMMUTATORI PIASTRE*
PLATES DELTA-STAR SWITCHES*

– ALTRE COMBINAZIONI TOP A RICHIESTA
– OTHER TOP COMBINATIONS ON REQUEST

6 MORSETTIERA ARRIVO LINEA
CONNECTION JUNCTION BLOCK

7 CORRIMANO LATERALE E POSTERIORE (A RICHIESTA CON EXTRA COSTO)
SIDE AND REAR HAND RAIL (ON REQUEST WITH EXTRA COST)

8 GRIGLIA DI VENTILAZIONE
VENTILATION GRID

– GRADO DI PROTEZIONE IP44
– PROTECTION DEGREE

*LA QUANTITA' DEI COMMUTATORI VARIA SECONDO I MODELLI
*QUANTITY OF DELTA STAR WILL BE ACCORDING TO THE MODEL

PIASTRE DISPONIBILI PER TOP – AVAILABLE PLATE FOR RANGE TOP

PIASTRA – HOT PLATE
mm 300X300 kW 2,4

PIASTRA – HOT PLATE
mm 300X610 kW 4,8

PIASTRA – HOT PLATE
mm 600X610 kW 4,8x2

BISTECCHIERA LISCIA – SMOOTH GRIDDLE
mm 300X610 kW 4,8

BISTECCHIERA RIGATA – GROOVED GRIDDLE
mm 300X610 kW 4,8

BISTECCHIERA LISCIA – SMOOTH GRIDDLE
mm 600X610 kW 4,8x2

BISTECCHIERA RIGATA – GROOVED GRIDDLE
mm 600X610 kW 4,8x2

BISTECCHIERA LISCIA/RIGATA
SMOOTH/GROOVED GRIDDLE
mm 600X610 kW 4,8x2